



# Aspen-BG<sup>Plus</sup>

## Blood Gas and Chemistry Analyzer

Parameter	Reportable Range	Resolution	Measurement method
pH (pH units)	6.5-8.20	0.001	Potentiometric sensor
pO <sub>2</sub> (mmHg)	10-700	0.1	Amperometric sensor
pCO <sub>2</sub> (mmHg)	10-150	0.1	Potentiometric sensor
Na (mmol/L)	100-180	0.1	Potentiometric sensor
K (mmol/L)	2.0-9.0	0.01	Potentiometric sensor
Ca (mmol/L)	0.25-2.5	0.01	Potentiometric sensor
Cl (mmol/L)	65-140	0.1	Potentiometric sensor
Glu (mg/dL or mmol/L)	20-700/1.1-38.9	1/0.1	Amperometric sensor
Lac (mg/dL or mmol/L)	0.3-20/2.7-180.2	0.01/0.1	Amperometric sensor
Hct (%PCV or Fraction)	10-75 0.10-0.75	1%/0.01	Conductance sensor

### Specification

Throughput	Results in 1 minute after sample aspiration
Sample volume	140µl
Quality control	3 or 5 levels QC, External electronic simulator
Display	7-inch color LCD Display, 800*480
Interface	4 x USB 2.0 host, 1 x RS232, WLAN
Input device	Touch screen and barcode scanner
Power supply	100~240VAC, 50/60Hz
Battery	4200mAh rechargeable lithium-ion battery, 50 samples continuous testing
Dimensions (W*H*D)	238*153*310 mm
Weight	3.65 KG
Operation Environment	10°C-31°C; %RH: 25%-80%; 700-1066 KPa



# Aspen-BG<sup>Plus</sup>

## Blood Gas and Chemistry Analyzer



*Care for Health*



Local Contact

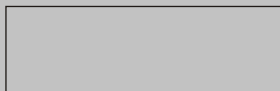

LAN/Wi-Fi connectivity Build-in Printer and USB Storage



#### Small and portable

- Small size (315\*238\*153mm)
- Light weight<4 kg (including battery)
- Build-in high capacity rechargeable battery

#### Friendly User Interface

- Color LCD touch screen display
- “traffic light” indicator
- Build-in multimedia tutorials

#### Unique smart cartridge design

- Single use cartridge with multi tests
- Safety and Environment protection
- Long cartridge storage life at room temperature

#### Convenient operation, accurate and reliable results

- Standby without consumption and complete maintenance free
- Fast, accurate and convenient build-in auto calibration
- Auto sample aspiration assures convenience and reliability

#### Powerful Data Management

- USB ports for data transfer
- 10,000 patient data storage
- Optional data management software
- Seamless integration with LIS/HIS through wired or wireless networking



Portable and lightweight

Touch screen with built-in multimedia tutorials

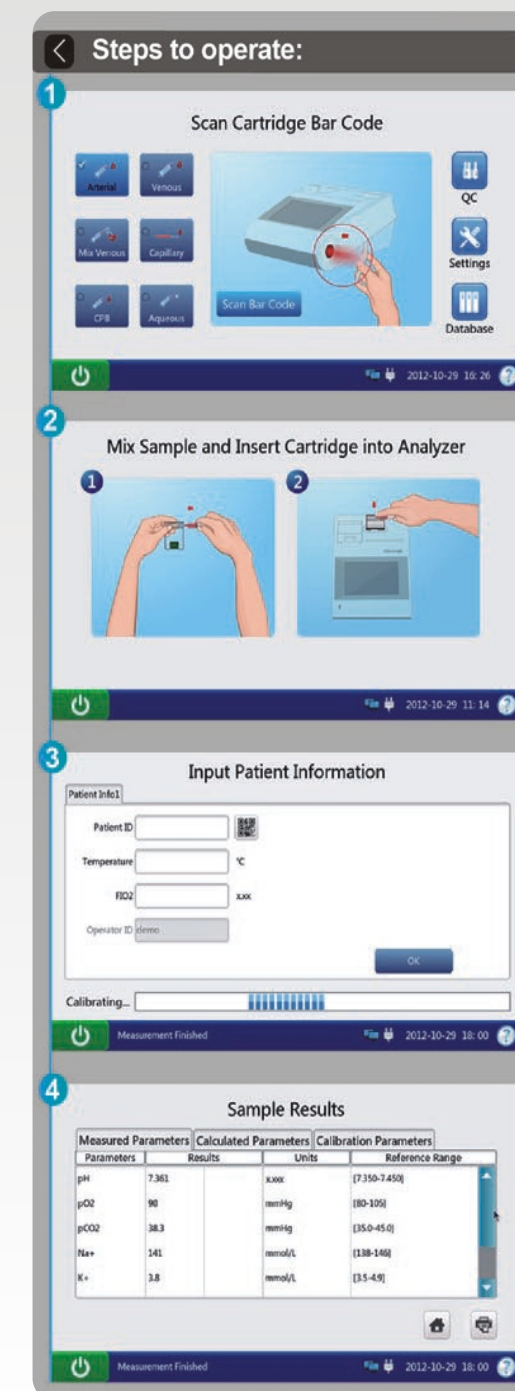

# Aspen-BG<sup>Plus</sup>

## Blood Gas and Chemistry Analyzer

Advanced cartridge technology Smart cartridges (five in one)



#### 1. MLC

Microchip liquid control technology can ensure the tightness and reaction speed of liquid flow to improve precision and accuracy, meanwhile it can achieve the miniaturization and maintenance free for analyzer.

#### 2. MMM

Microsensor multifunction membrane technology is the core technology to improve the high sensitivity and variety of tests

#### 3. SAM

Innovative sensor array microfluidics design can accurately measure the volume of sample and reagent to improve the precision and accuracy

#### 4. AC

Reliable analyzer auto-calibration provide multipoint calibration curve in factory and one-point check by inducer which can eliminate the error between different analyzers and tests

#### 5. TR

Adopting international accepted traceability calibrator and quality control, analyzer can get highly comparable results with central lab.

Variety of test Cartridges

	pH	pCO <sub>2</sub>	pO <sub>2</sub>	Na	K	Cl	Ca	Hct	Glu	Lac
BG3	—	—	—	—	—	—	—	—	—	—
BG8	—	—	—	—	—	—	—	—	—	—
BG4	—	—	—	—	—	—	—	—	—	—
BG9	—	—	—	—	—	—	—	—	—	—
BG10	—	—	—	—	—	—	—	—	—	—

**Calculated values:** HCO<sub>3</sub>-act, HCO<sub>3</sub>-std, BE(ecf), BE(B), BB(B), ctCO<sub>2</sub>, sO<sub>2</sub>(est), Ca<sup>++</sup>(7.4), AnGap, tHb(est), pO<sub>2</sub>(A-a), pO<sub>2</sub>(a/A), RI, pO<sub>2</sub>/FIO<sub>2</sub>, cH<sup>+</sup>(T), pH(T), pCO<sub>2</sub>(T), pO<sub>2</sub>(T), pO<sub>2</sub>(A-a)(T), pO<sub>2</sub>(a/A)(T), RI(T), pO<sub>2</sub>(T)/FIO<sub>2</sub>, Ca<sup>++</sup>(7.4)